

CORNER BAY & BALCONY DETAIL

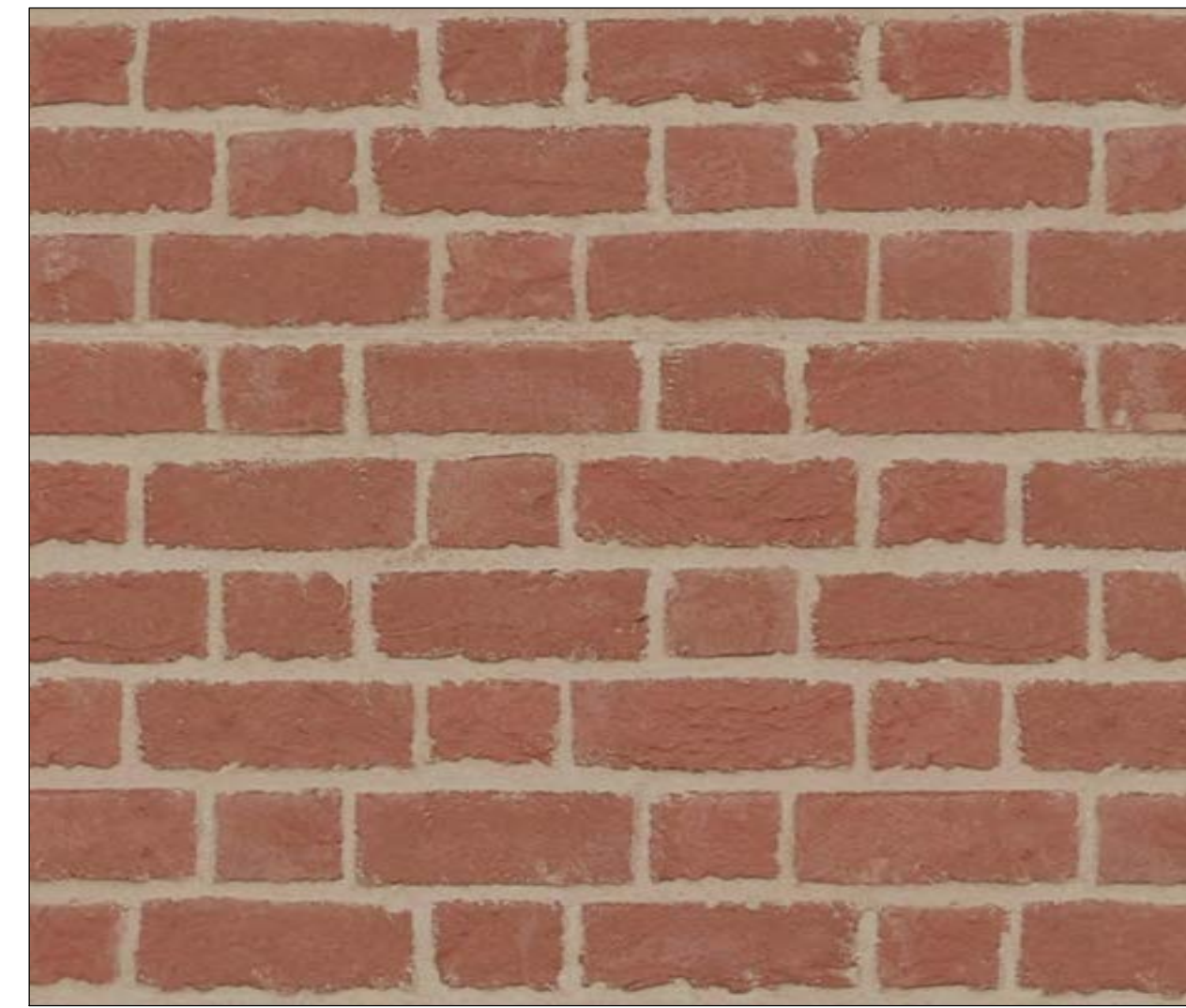

MP-1



BR-1

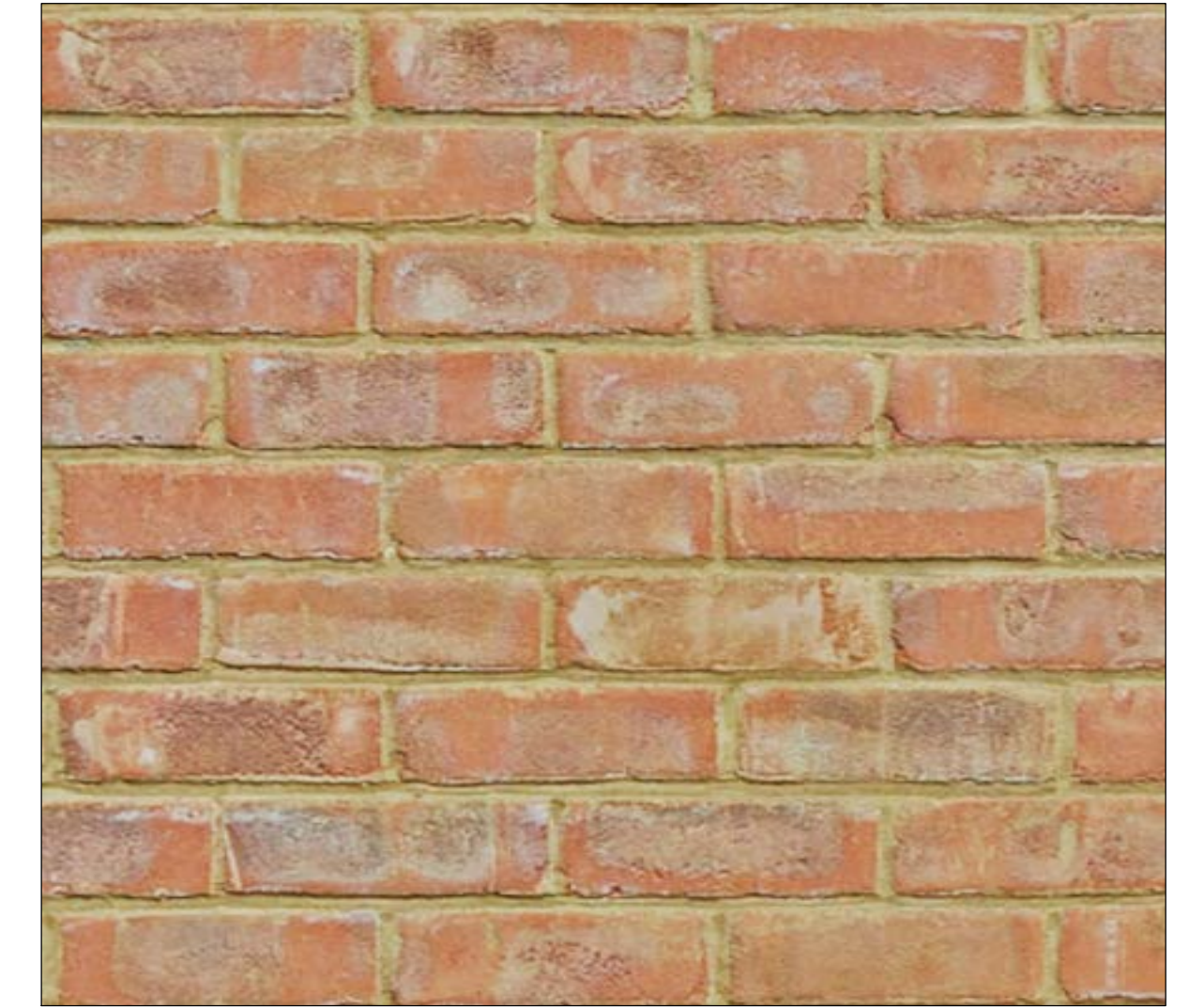

BR-2



ENLARGED ELEVATION



MP-1



BR-2

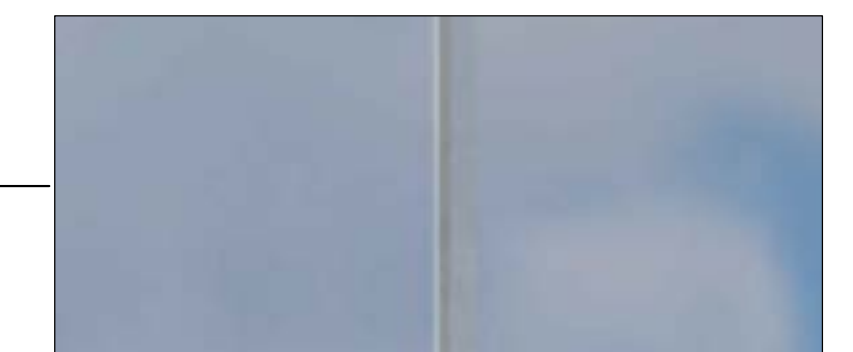

SUNGARD NEUTRAL 61 ON CLEAR



FAIR FACED CONCRETE



BR-1



1ST FLOOR CORNER & PEDESTRIAN PAVERS

RICH MARKUS
ARCHITECTS
2601 P STREET NW, 2ND FLR
WASHINGTON DC 20007
202.333.2877 V

SOUTH CAPITOL
STREET SW,
WASHINGTON D.C.

BUILDING MATERIALS
& DETAIL VIEWS

NO.	REVISIONS

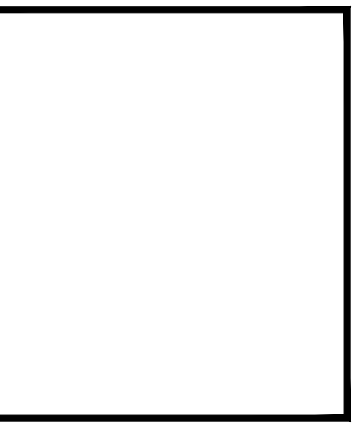

N.T.S

09.02.2022

A401
ZONING COMMISSION
DRAWING NUMBER



SOUTH CAPITOL STREET AND N STREET VIEW

RICH MARKUS
ARCHITECTS

2601 P STREET NW, 2ND FLR
WASHINGTON DC 20007
202.333.2877 V

SOUTH CAPITOL
STREET SW,
WASHINGTON D.C.

PROPOSED VIEW

	REVISIONS

AS SHOWN

09.19.2022

A500

DRAWING NUMBER



SOUTH CAPITOL ST. SW VIEW

RICH MARKUS
ARCHITECTS

2601 P STREET NW, 2ND FLR
WASHINGTON DC 20007
202.333.2877 V

SOUTH CAPITOL
STREET SW,
WASHINGTON D.C.

PROPOSED VIEW

NO.	REVISIONS

AS SHOWN SCALE

09.19.2022 ISSUE

A501

DRAWING NUMBER



N STREET SW

RICH MARKUS
ARCHITECTS

2601 P STREET NW, 2ND FLR
WASHINGTON DC 20007
202.333.2877 V

SOUTH CAPITOL
STREET SW,
WASHINGTON D.C.

PROPOSED DETAIL
VIEWS

NO.	REVISIONS

AS SHOWN

09.19.2022

A502

DRAWING NUMBER



CORNER OUTDOOR SPACE

RICH MARKUS
ARCHITECTS

2601 P STREET NW, 2ND FLR
WASHINGTON DC 20007
202.333.2877 V

SOUTH CAPITOL
STREET SW,
WASHINGTON D.C.

PROPOSED DETAIL
VIEWS

REVISIONS

AS SHOWN

09.19.2022

A503

DRAWING NUMBER



N STREET OUTDOOR SPACE

RICH MARKUS
ARCHITECTS

2601 P STREET NW, 2ND FLR
WASHINGTON DC 20007
202.333.2877 V

SOUTH CAPITOL
STREET SW,
WASHINGTON D.C.

PROPOSED DETAIL
VIEWS

NO.	REVISIONS

AS SHOWN SCALE

09.19.2022 ISSUE

A504
DRAWING NUMBER



N STREET OUTDOOR SPACE

RICH MARKUS
ARCHITECTS

2601 P STREET NW, 2ND FLR
WASHINGTON DC 20007
202.333.2877 V

SOUTH CAPITOL
STREET SW,
WASHINGTON D.C.

PROPOSED DETAIL
VIEWS

NO.	REVISIONS

AS SHOWN

09.19.2022

A505

DRAWING NUMBER



SOUTH CAPITOL ST VIEW

RICH MARKUS
ARCHITECTS
2601 P STREET NW, 2ND FLR
WASHINGTON DC 20007
202.333.2877 V

SOUTH CAPITOL
STREET SW,
WASHINGTON D.C.

PROPOSED VIEW

NO.	REVISIONS

AS SHOWN

09.19.2022

A506

DRAWING NUMBER



BIRDS EYE VIEW

RICH MARKUS
ARCHITECTS

2601 P STREET NW, 2ND FLR
WASHINGTON DC 20007
202.333.2877 V

SOUTH CAPITOL
STREET SW,
WASHINGTON D.C.

PROPOSED VIEW

REVISIONS

AS SHOWN

09.19.2022

A507

DRAWING NUMBER



N- STREET VIEW

RICH MARKUS
ARCHITECTS

2601 P STREET NW, 2ND FLR
WASHINGTON DC 20007
202.333.2877 V

SOUTH CAPITOL
STREET SW,
WASHINGTON D.C.

PROPOSED VIEW

NO.	REVISIONS

AS SHOWN

09.19.2022

A508

DRAWING NUMBER



SOUTH CAPITOL STREET VIEW

RICH MARKUS
ARCHITECTS

2601 P STREET NW, 2ND FLR
WASHINGTON DC 20007
202.333.2877 V

SOUTH CAPITOL
STREET SW,
WASHINGTON D.C.

PROPOSED VIEW

NO.	DESCRIPTION	DATE



AS SHOWN

09.19.2022

A509

DRAWING NUMBER

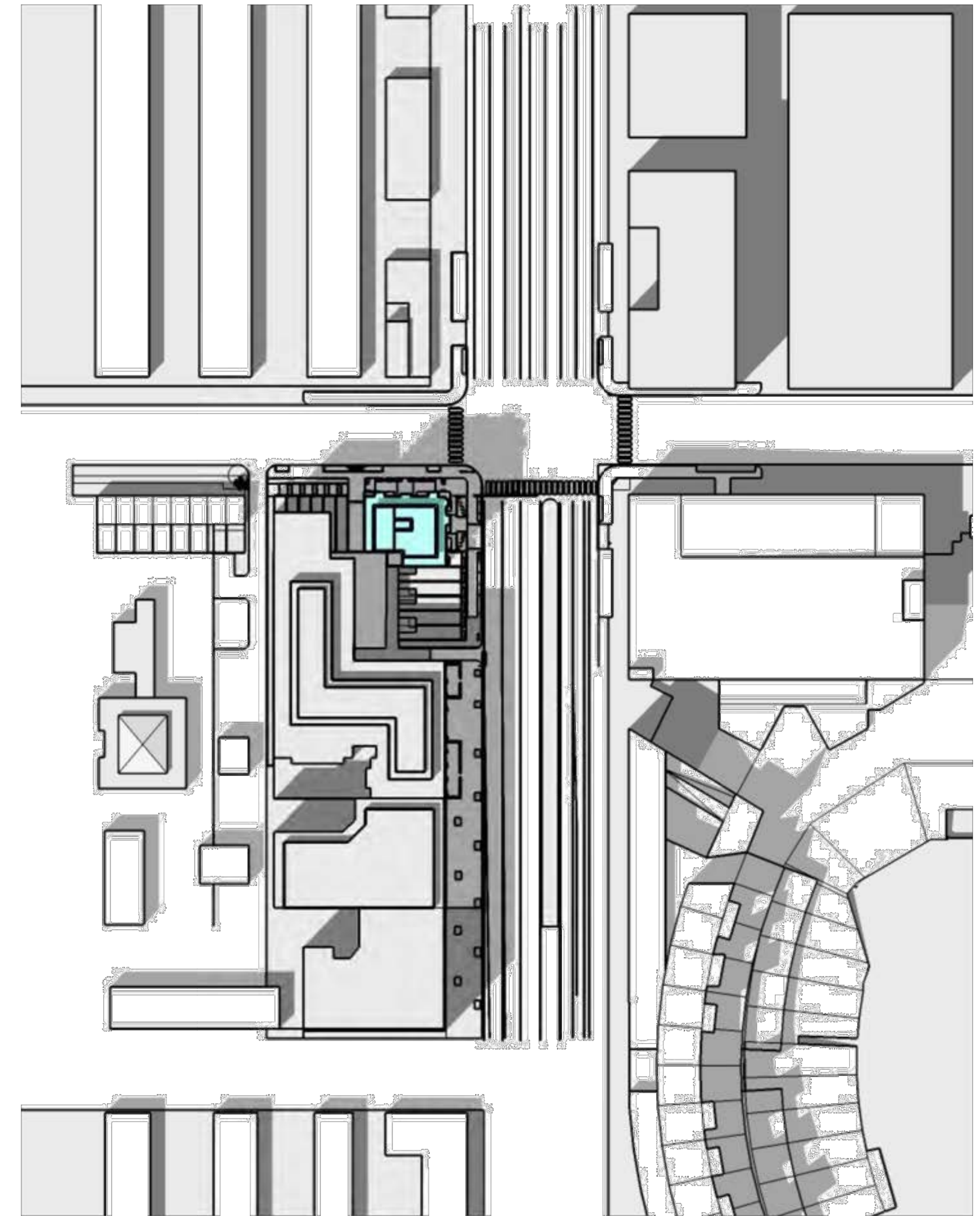
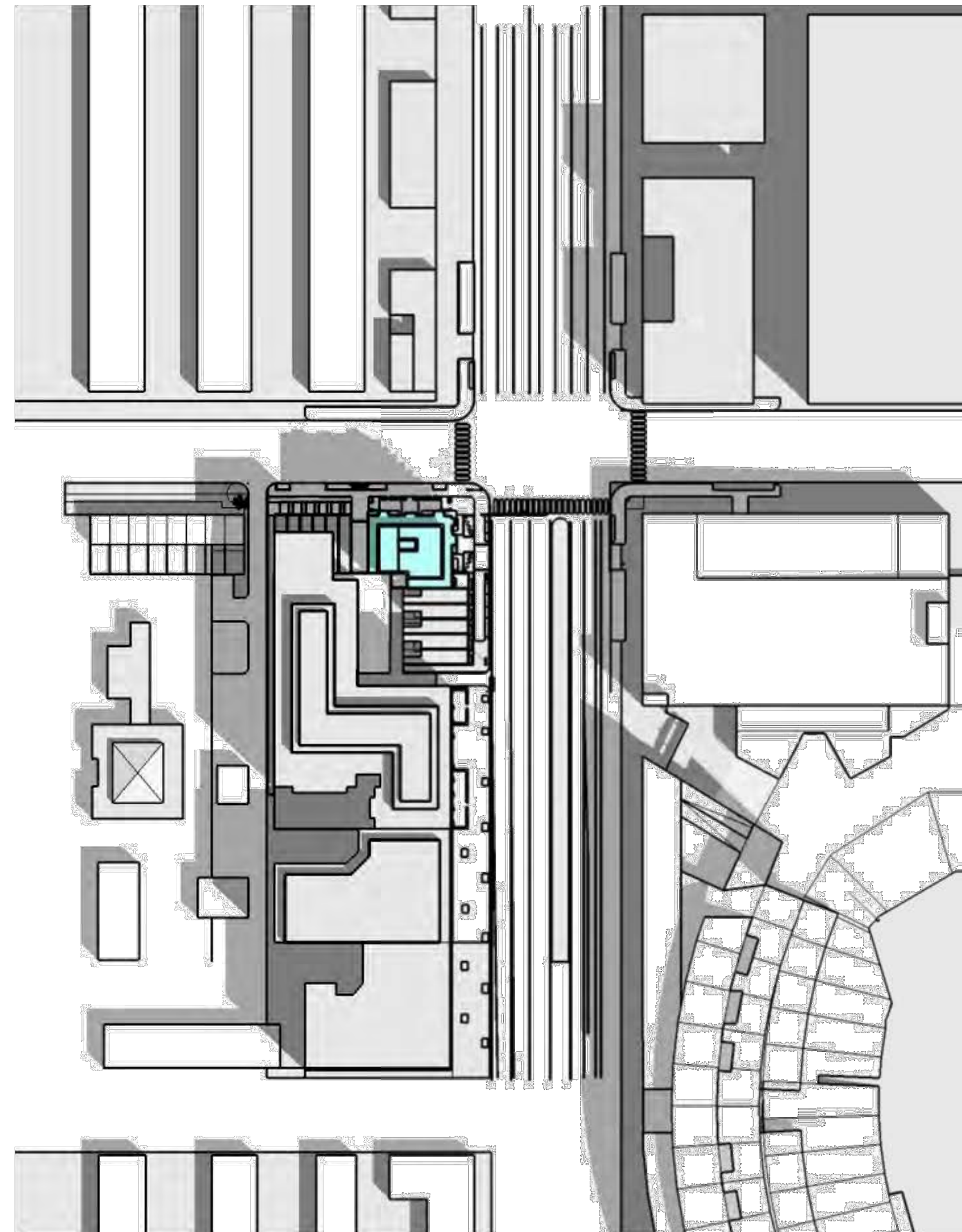
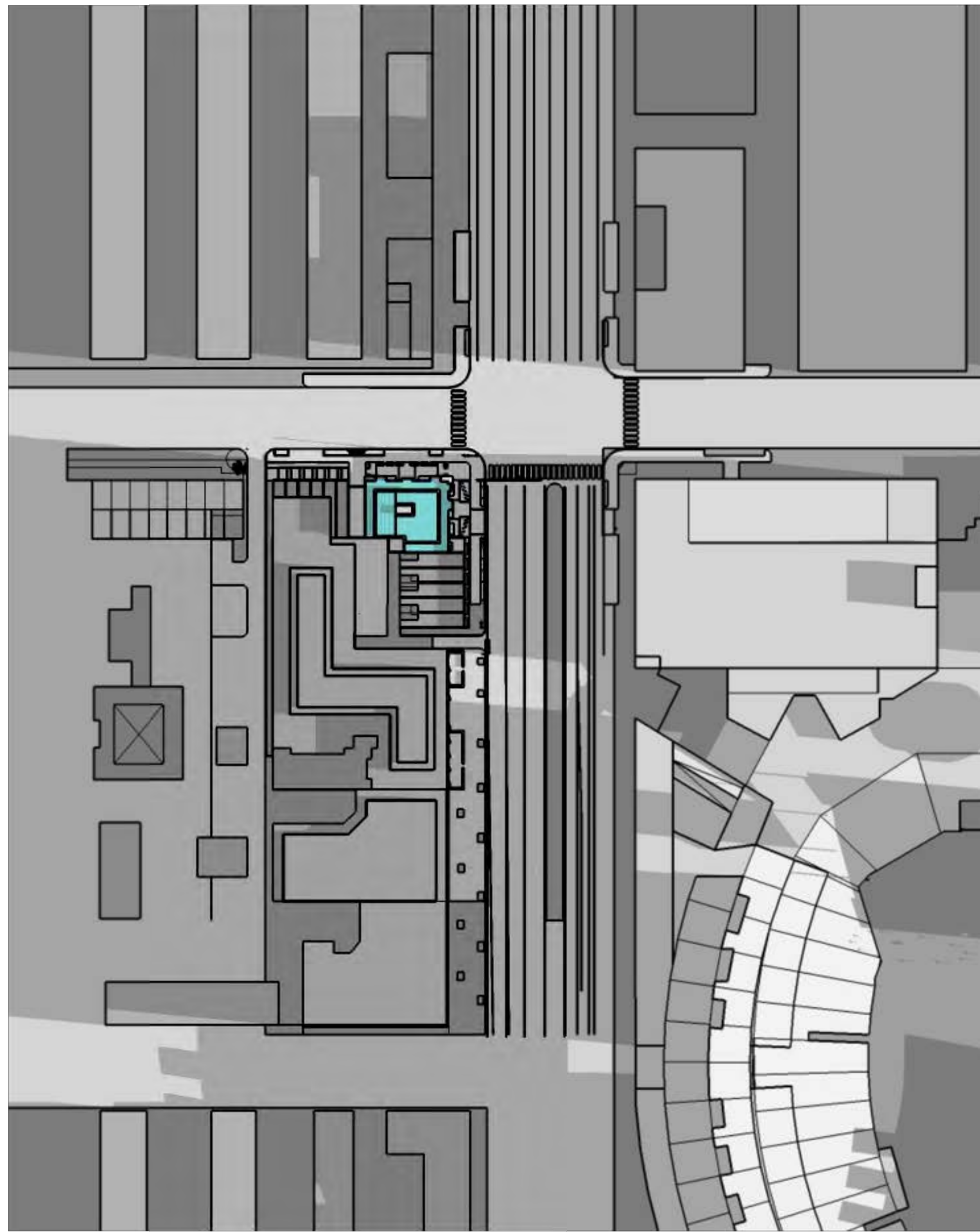

1 March/September @9:00AM
NTS

2 March/September @12:00PM
NTS

3 March/September @4:00PM
NTS

RICH MARKUS
ARCHITECTS

2601 P STREET NW, 2ND FLR
WASHINGTON DC 20007
202.333.2877 V

SOUTH CAPITOL
STREET SW,
WASHINGTON D.C.

SHADOW STUDY

NO.	REVISIONS

AS SHOWN

07.18.2022

A510

DRAWING NUMBER

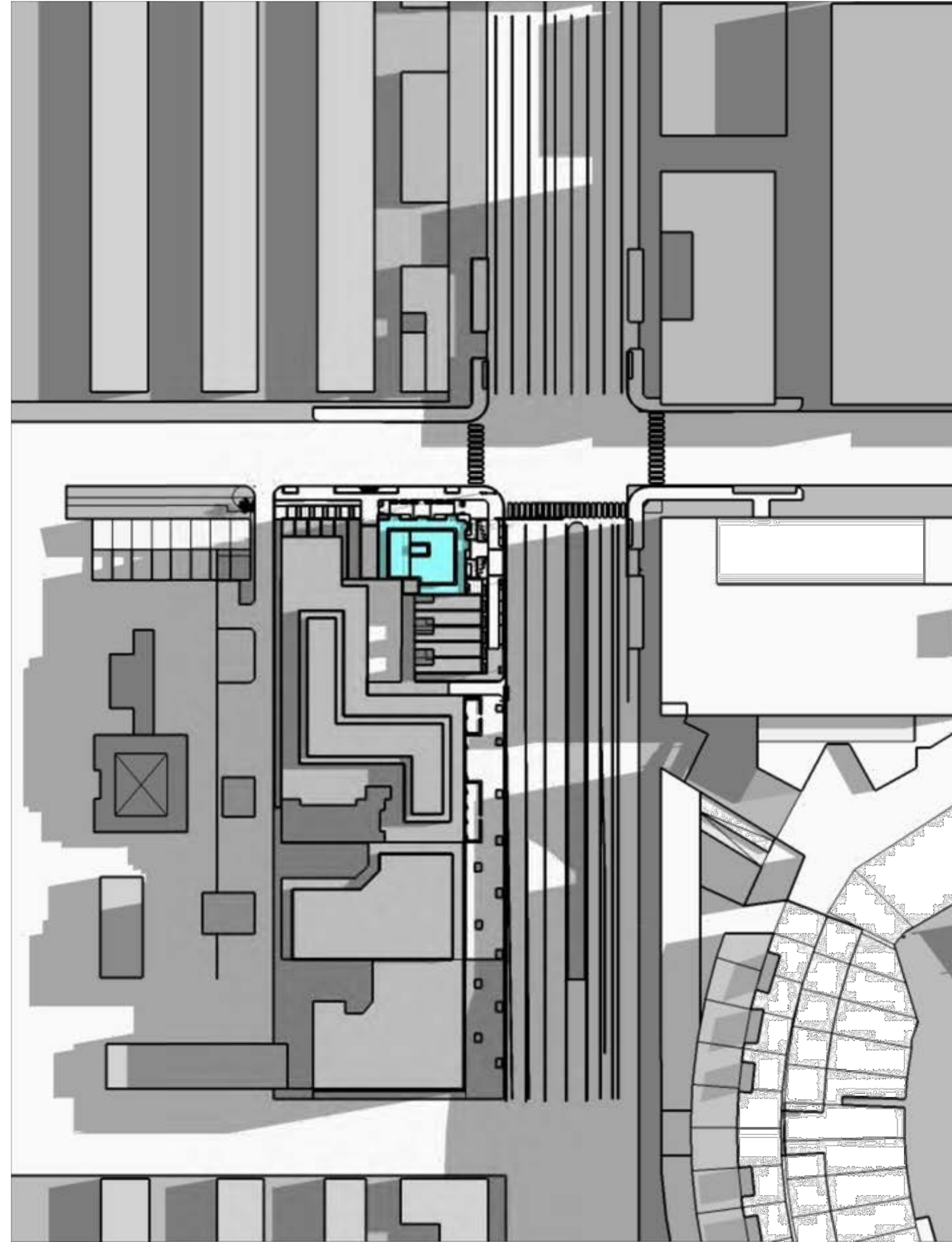

1 JULY 01 @9:00AM
NTS

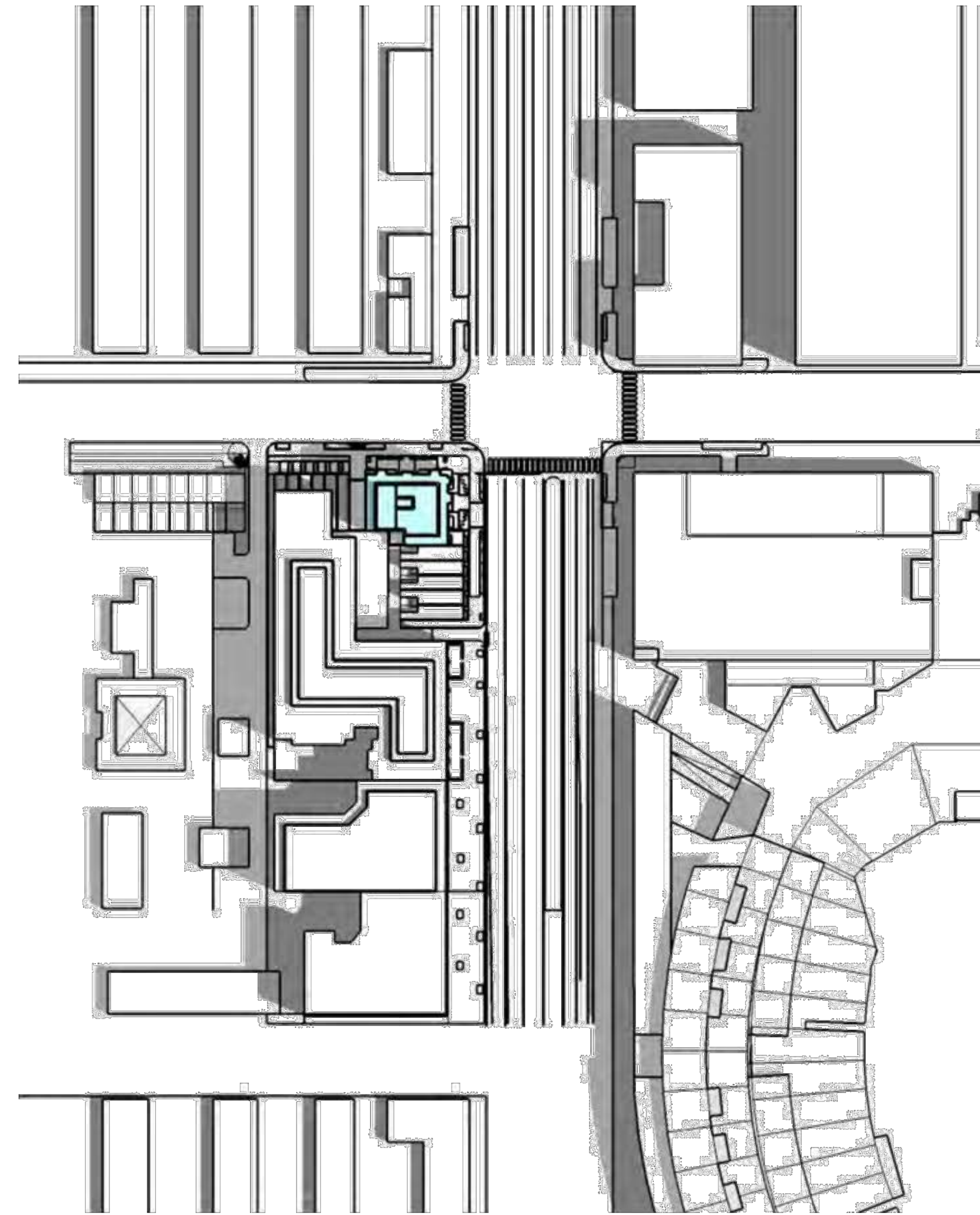

2 JULY 01 @12:00PM
NTS

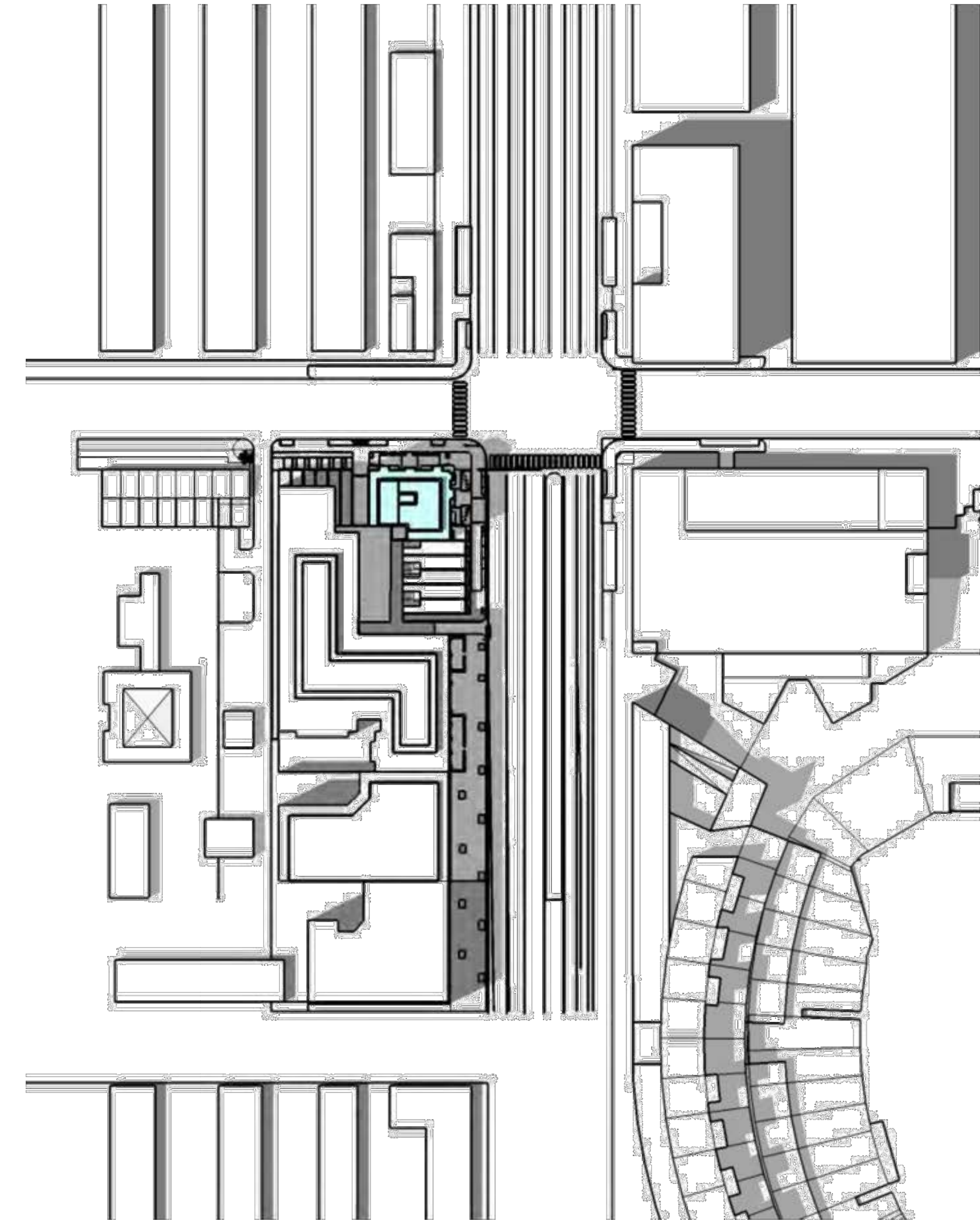

3 JULY 01 @4:00PM
NTS

RICH MARKUS
ARCHITECTS

2601 P STREET NW, 2ND FLR
WASHINGTON DC 20007
202.333.2877 V

SOUTH CAPITOL
STREET SW,
WASHINGTON D.C.

SHADOW STUDY

NO.	REVISIONS

AS SHOWN

07.18.2022

A511

DRAWING NUMBER

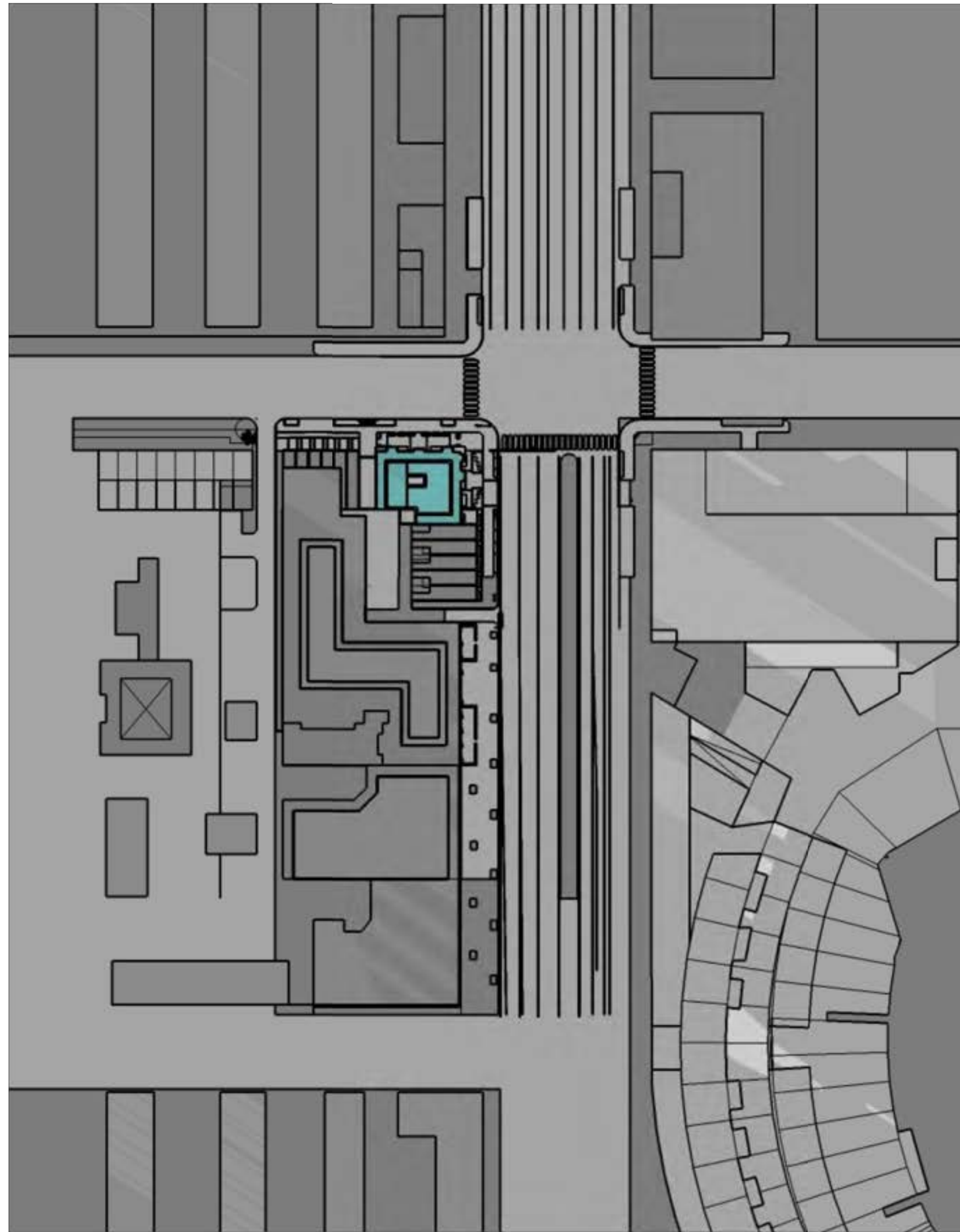

1 DECEMBER 01 @9:00AM
NTS

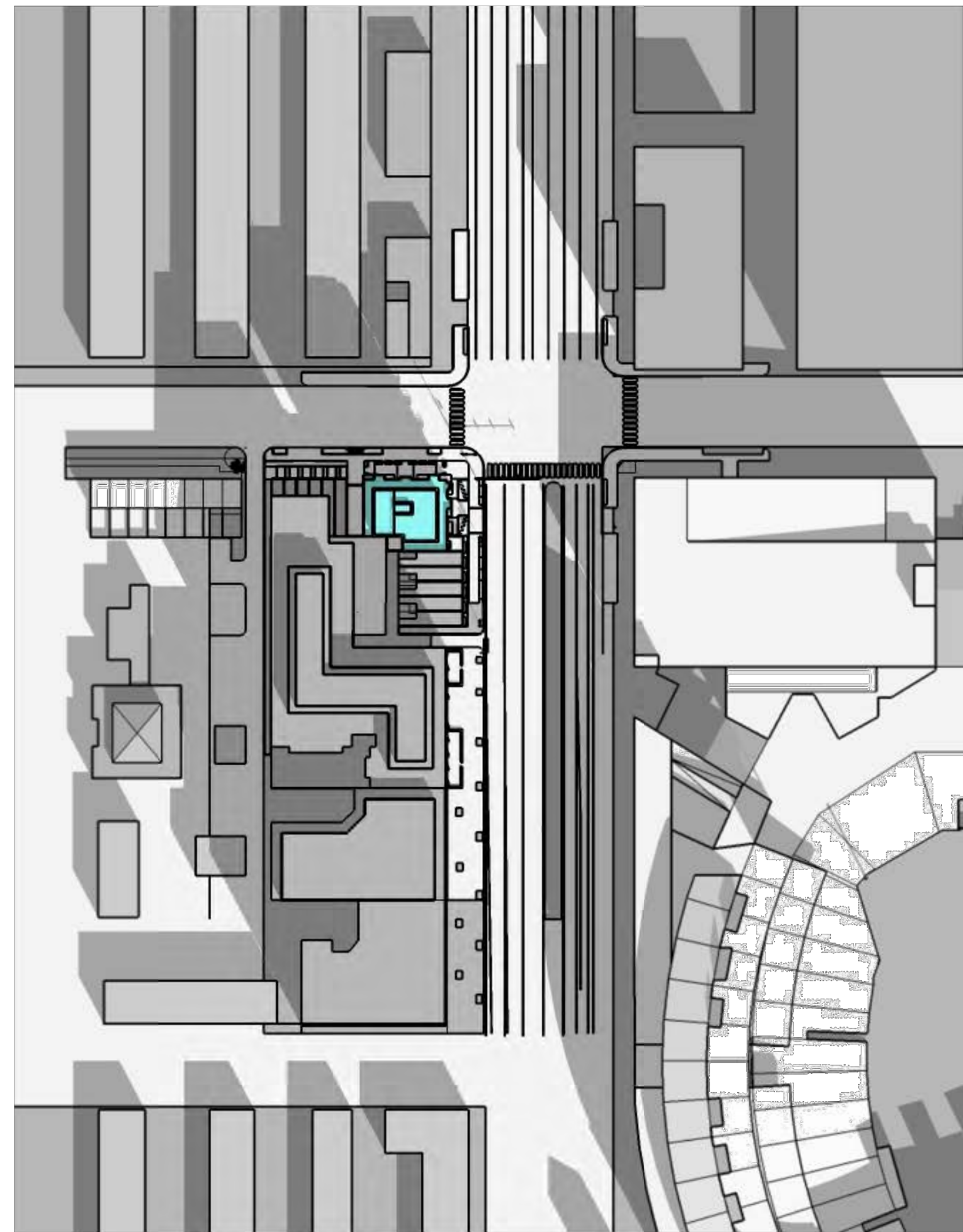

2 DECEMBER 01 @12:00PM
NTS

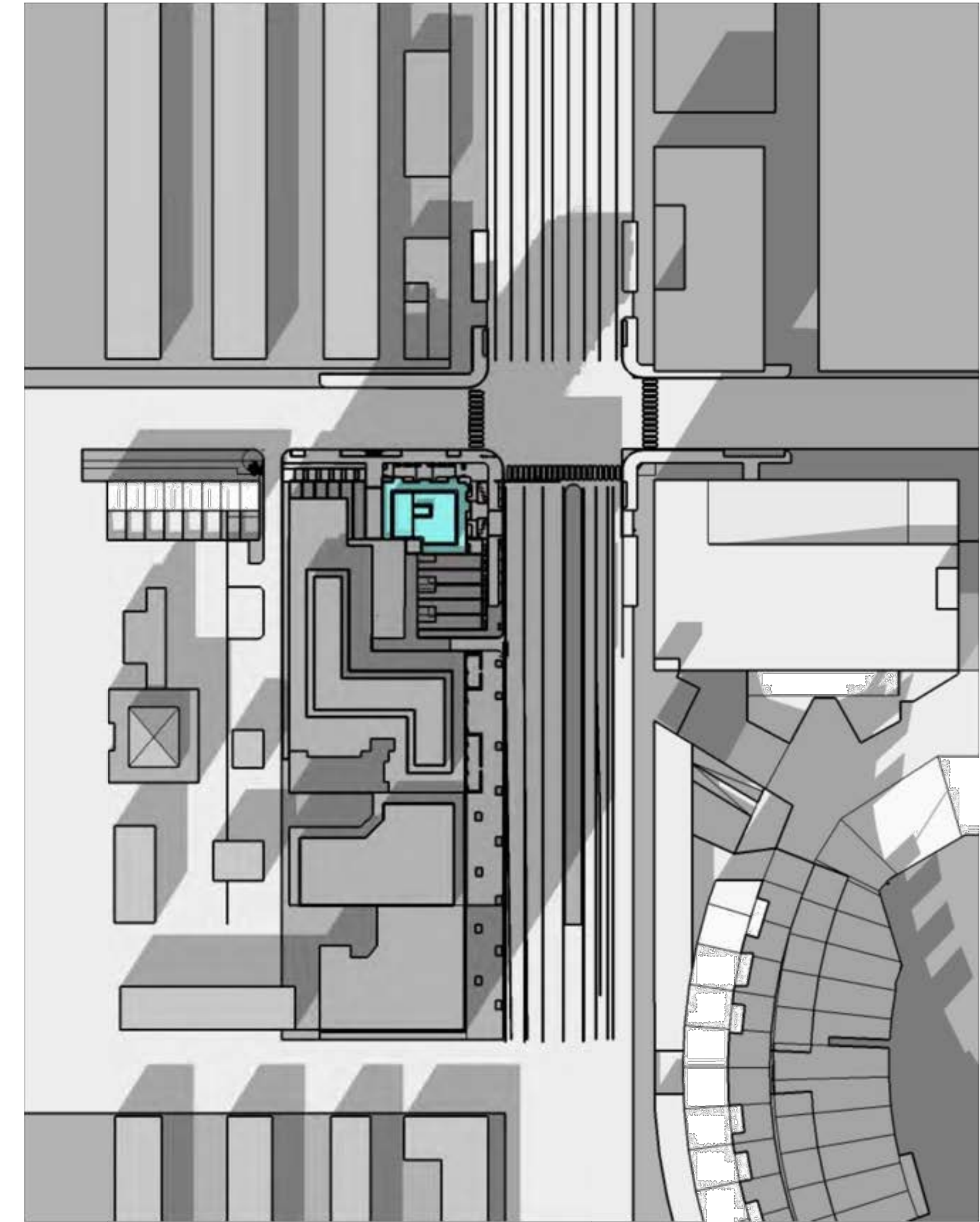

3 DECEMBER 01 @4:00PM
NTS

RICH MARKUS
ARCHITECTS
2601 P STREET NW, 2ND FLR
WASHINGTON DC 20007
202.333.2877 V

SOUTH CAPITOL
STREET SW,
WASHINGTON D.C.

SHADOW STUDY

REVISIONS

AS SHOWN SCALE

07.18.2022 ISSUE

A512

DRAWING NUMBER